

\$83,000 - 1575 Gould (2 Lots) Avenue Sw, Palm Bay

MLS® #1035517

\$83,000

0 Bedroom, 0.00 Bathroom,
Land on 0.46 Acres

Port Malabar Unit 32, Palm Bay, FL

BEAUTIFUL, WOODED DOUBLE LOT ON A PAVED ROAD. JUST A BLOCK OFF THE MAIN ROAD IN AN EASY TO FIND LOCATION. THIS .46 ACRE PARCEL GIVES YOU PLENTY OF ROOM TO SPREAD OUT. OR, VERIFY WITH THE PROPERTY APPRAISER THAT YOU CAN SPLIT IT BACK INTO 2 LOTS TO BUILD SIDE BY SIDE HOUSES. CONVENIENTLY LOCATED CLOSE TO AREA SCHOOLS AND THE POPULAR BAYSIDE LAKES COMMERCIAL AREA. THERE YOU WILL FIND A PUBLIX, WALGREENS, DUNKIN, STARBUCKS AS WELL AS RESTAURANTS, BANKING AND MORE! OR HEAD UP TO THE BUSY MALABAR RD CORRIDOR PROVIDING A WONDERFUL VARIETY OF BIG NAME STORES, RESTAURANTS AND I-95 ACCESS FOR YOUR DAILY COMMUTE. THIS SITE UTILIZES WELL WATER AND SEPTIC. TAKE A DRIVE BY!

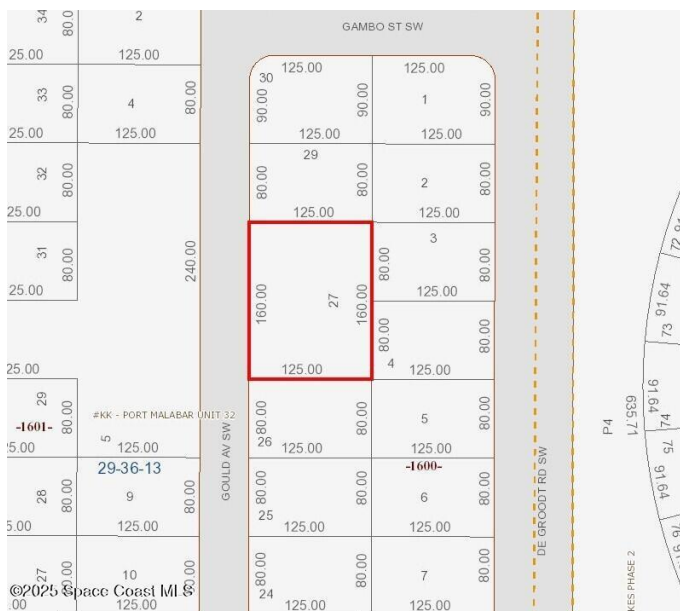

Essential Information

MLS® #	1035517
Price	\$83,000
Bathrooms	0.00
Acres	0.46
Type	Land
Sub-Type	Unimproved Land
Status	Active

Community Information

Address	1575 Gould (2 Lots) Avenue Sw
Area	345 - SW Palm Bay
Subdivision	Port Malabar Unit 32
City	Palm Bay
County	Brevard
State	FL
Zip Code	32908

Amenities

Utilities	Sewer Not Available, Water Not Available
View	Trees/Woods

Exterior

Lot Description	Wooded
-----------------	--------

School Information

Elementary	Westside
Middle	Southwest
High	Bayside

Listing Details

Listing Office	Cheryl Smith Realty, Inc
----------------	--------------------------

The information being provided by the Space Coast Association of REALTORS® is exclusively for consumers' personal, non-commercial use, and it may not be used for any purpose other than to identify prospective properties consumers may be interested in purchasing. The data is deemed reliable but is not guaranteed accurate by the MLS.